



STAINLESS STEEL
REGALINE SINKS
 One & Two Compartments without Drainboards



"930" and "900" Series shown



"940" Series shown

Item #: _____ Qty #: _____
 Model #: _____
 Project #: _____



Recessed Bowl Surface
 Accommodates
 Poly-Vance Cutting Boards
 & Sink Covers

FEATURES:

- Tile edge for ease of installation.
- One piece **Deep Drawn** sink bowls with splash.
- Featuring the single bowl unit design.
- All sink bowls have a large liberal 3" radius.
- Placement of the welded leg assembly ensures stability and furnishes direct support of the column load requirement for the entire sink unit.
- "940" series is supplied with adjustable front and rear cross brace featuring leg casting to secure left to right cross bracing.

CONSTRUCTION:

- All TIG welded.
- Welded areas blended to match adjacent surfaces and to a satin finish.
- Gussets welded to a die-embossed reinforcing channel.

MATERIALS:

- Spec-Line (940 Series):** 14 gauge type 304 stainless steel 11" High Splash.
- Standard (930 Series):** 16 gauge type 304 stainless steel 8" High Splash.
- Super Saver (900 Series):** 18 gauge type 304 stainless steel 8" High Splash.
- LEGS:**
 - 1 5/8" diameter tubular stainless steel.
 - Stainless steel gussets & channels.
 - Stainless Steel 1" adjustable bullet feet.

YES! It's SeaLess!

BOWL SIZE	O.A. LENGTH (inches) (mm)	# of Compartment	SPEC-LINE 940 Series		STANDARD 930 Series		SUPER SAVER 900 Series		Cubic Feet
			MODEL #	Approx. Wt. (lbs.)	MODEL #	Approx. Wt. (lbs.)	MODEL #	Approx. Wt. (lbs.)	
16 x 20 (406 x 508)	25" 635	One	94-1-24	77	93-1-24	66	9-1-24	49	20
	44" 1118	Two	94-2-36	109	93-2-36	76	9-2-36	66	20
20 x 20 (508 x 508)	29" 737	One	94-21-20	92	93-21-20	60	9-21-20	61	20
	52" 1321	Two	94-22-40	116	93-22-40	80	9-22-40	79	23
18 x 24 (457 x 610)	27" 686	One	94-61-18	95	93-61-18	78	9-61-18	69	44
	48" 1207	Two	94-62-36	165	93-62-36	154	9-62-36	129	56
24 x 24 (610 x 610)	33" 838	One	94-41-24	93	93-41-24	85	9-41-24	85	23
	60" 1524	Two	94-42-48	174	93-42-48	145	9-42-48	145	31
20 x 28 (508 x 711)	29" 737	One	94-81-20	123	93-81-20	97	9-81-20	97	27
	52" 1321	Two	94-82-40	185	93-82-40	160	9-82-40	160	45
			14" Water Level 17" Flood Level		12" Water Level 15" Flood Level		12" Water Level 15" Flood Level		



Customer Service Available To Assist You **1-800-645-3166** 8:30 am - 8:00 pm E.S.T.

For Orders & Customer Service:
 Email: customer@advancetabco.com or Fax: 631-242-6900

For Smart Fabrication™ Quotes:
 Email: smartfab@advancetabco.com or Fax: 631-586-2933

DIMENSIONS and SPECIFICATIONS

TOL Overall: ± .500"
Interior: ± .250"

ALL DIMENSIONS ARE TYPICAL

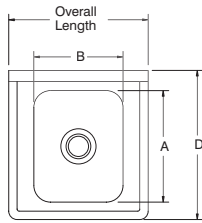

1 Compartment

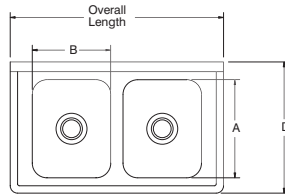
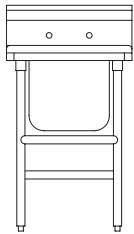

2 Compartment

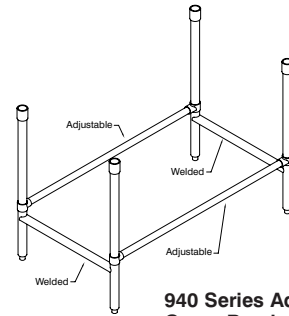
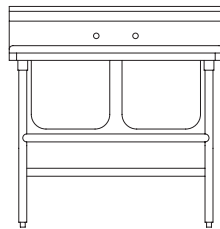

940 Series Adjustable Cross Bracing

DESCRIPTION

BOWL (SIZE)	# of Compart.	Overall Length	Recommended Use	A	B	C	D	940 SERIES					900 & 930 SERIES				
								V	W	X	Y	Z	V	W	X	Y	Z
16x20	One	25"	DISH SINKS	20"	16"	13 5/8"	27"	38"	11"	14"	20"	45"	38"	8"	12"	22"	42"
	Two	44"															
20x20	One	29"	DISH & POT SINKS	20"	20"	13 5/8"	27"	38"	11"	14"	20"	45"	38"	8"	12"	22"	42"
	Two	52"															
18x24	One	27"	POT & PAN SINKS	24"	18"	15 5/8"	31"	38"	11"	14"	20"	45"	38"	8"	12"	22"	42"
	Two	48"															
24x24	One	33"	POT SINKS	24"	24"	15 5/8"	31"	38"	11"	14"	20"	45"	38"	8"	12"	22"	42"
	Two	60"															
20x28	One	29"	PAN SINKS	28"	20"	17 5/8"	35"	38"	11"	14"	20"	45"	38"	8"	12"	22"	42"
	Two	52"															

PLUMBING ROUGH-IN

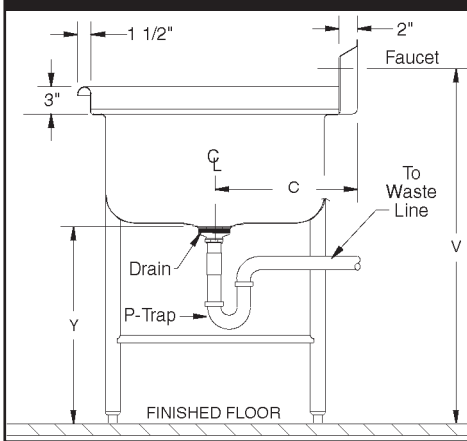

MECHANICAL:

- Supply is 1/2" IPS hot & cold.
- Faucet holes on 8" centers.
- Faucets are not included (see accessories).
- Waste drains are 1 1/2" IPS S/S basket type, located in center of sink bowl, and are included.



SECTION

